

# H&S

## 7' & 8' HAY TEDDERS

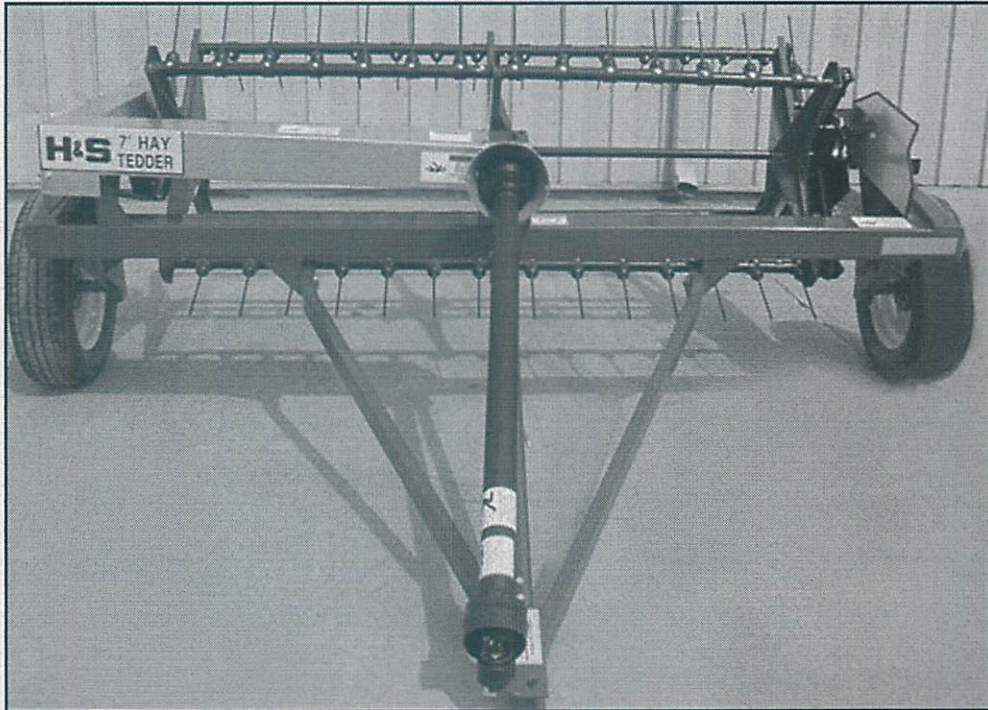

**WARNING** READ AND UNDERSTAND THIS MANUAL BEFORE OPERATING THIS EQUIPMENT.

UNSAFE OPERATION OR MAINTENANCE OF THIS EQUIPMENT CAN RESULT IN SERIOUS INJURY OR DEATH.

### OPERATOR'S MANUAL and PARTS LIST

01-15-08

Manufactured By

**H&S MANUFACTURING CO., INC.**

P.O. BOX 768 • (715) 387-3414 FAX (715) 384-5463

MARSHFIELD, WISCONSIN 54449

# H&S

## 7' & 8' HAY TEDDERS

### OPERATOR'S AND PARTS MANUAL

#### CONTENTS

Warranty & Warranty Registration Card.....	1-2
Dealer Pre-Delivery & Delivery Checklist.....	3
Be Alert Symbol .....	5
Explanation of Safety Signs .....	6
Danger and Warning Decals .....	7
Warning - Owner Must Read and Understand.....	8
Operation and Adjustments.....	9
Lubrication Guide.....	10-11
Decal Location and Identification .....	12
Ordering Parts.....	13
Figure 1 Frame and Shields - Description .....	14-15
Figure 2 Cam and Belt Drive Assembly - Description .....	16-17
Figure 3 Bevel Gear Box - Description.....	18
Figure 4 PTO Parts - Description (2005 Only).....	19
Figure 5 PTO Parts - Description (Beginning w/2006 Model).....	20
Specifications .....	Back Inside Cover

# WARRANTY

## Mr. Owner: Before Operating—Read and Understand Operating and Safety Instructions

H&S Manufacturing Co., Inc. truly believes you have made a wise choice and a sound and lasting investment. Many years of development have made available these quality machines to assure you the performance and reliability you need. **We ask you to read the following agreement and warranty as this unit is subject to this warranty and agreement and no other.**

### THE H&S WARRANTY

H&S Manufacturing Co., Inc. ("H&S") warrants this product to be free from defect in material and workmanship. Except as noted below, this warranty term is twelve (12) months from the date of delivery of the product to the original purchaser by an authorized H&S dealer. Under this warranty, H&S will repair or replace, at its option, any covered part which is found to be defective in material or workmanship during the applicable warranty term. In no case will the covered repair cost of a part or parts exceed the replacement cost of that part. Warranty service must be performed by H&S or a dealer authorized by H&S to sell and/or service the product involved, which will use only new or remanufactured parts or components furnished by H&S. This warranty includes approved parts and labor to fix the product but does not include, and the purchaser is responsible for, any service call and/or transportation of the product to and from the dealer's place of business, for any premium charged for overtime labor requested by the purchaser, and for any service work not directly related to any defect covered under this warranty. This warranty includes only those components of the product manufactured by H&S. Warranty for any component not manufactured by H&S including, but not limited to, engines, batteries, tires, rims, hydraulic motors, pumps, etc. are covered by the warranty, if any, provided separately by their respective manufacturers.

This warranty in all its parts, is extended solely to the original purchaser of the product, is terminated upon any subsequent transfer or sale from or by the original purchaser and extends no third party benefits or rights whatsoever.

The warranty term for any product used in any commercial, custom, for hire or rental application, is limited to six (6) months from the date of delivery of the product to the original purchaser by an authorized H&S dealer.

Polybonded (polyethylene and plywood) panels utilized in H&S Manure Spreaders are warranted, to the original purchaser, to not wear through and the polyethylene overlay to not tear free of the plywood for the functional life of the spreader. This specific warranty on polybonded panels includes only replacement of any defective panel part without any allowance for labor beyond the terms of the general warranty (12 or 6 months), and is further limited to manure spreaders used to spread normal agricultural manure.

This warranty does not include: (1) Any product that has been altered or modified in ways not approved by H&S; (2) Depreciation or damage caused by normal wear, misuse, improper or insufficient maintenance, improper operation, accident or failure to follow the product Operator's Manual recommendations and product decal recommendations; (3) Normal maintenance parts and service; (4) Repairs made with parts other than those available from H&S or performed by anyone other than H&S or a dealer authorized by H&S to sell and/or service the product involved.

To secure warranty service the purchaser must report the product defect to a dealer authorized by H&S to sell and/or service the product involved within the applicable warranty term together with evidence of the warranty start date and make the product available to that dealer within a reasonable period of time.

**THERE ARE NO WARRANTIES WHICH EXTEND BEYOND THE DESCRIPTION ON THE FACE OF THIS WARRANTY. H&S and the companies affiliated with it makes no warranties, representations, or promises, express or implied, as to the performance or freedom from defect of its products other than those set forth above and NO IMPLIED WARRANTY OF MERCHANTABILITY, FITNESS OR FITNESS FOR A PARTICULAR PURPOSE IS MADE. IN NO EVENT WILL THE DEALER, H&S OR ANY COMPANY AFFILIATED WITH H&S BE LIABLE FOR INCIDENTAL OR CONSEQUENTIAL DAMAGES. The ONLY REMEDY the purchaser has in connection with the breach of performance of any warranty on H&S products are those set forth above.**

The selling dealer has no authority to make any representation or promise on behalf of H&S, or to modify the terms or limitations of this warranty in any way.

2/16/04

### WARRANTY REGISTRATION

Date of Purchase \_\_\_\_\_

Purchaser \_\_\_\_\_ Address \_\_\_\_\_

City \_\_\_\_\_ State \_\_\_\_\_ Zip \_\_\_\_\_

Product \_\_\_\_\_ Model # \_\_\_\_\_ Serial # \_\_\_\_\_

Dealer \_\_\_\_\_ Address \_\_\_\_\_

City \_\_\_\_\_ State \_\_\_\_\_ Zip \_\_\_\_\_

**FILL OUT AND MAIL  
IMMEDIATELY TO MAKE  
WARRANTY EFFECTIVE**



\_\_\_\_\_  
Signature of original buyer

**IMPORTANT!**

Tear on dotted line, provide the information requested on the card. The H&S Warranty is valid **“only”** after this card is received and recorded at H&S Mfg. Co. Mail at once. No postage is required in the U.S.A.

This is Your Warranty Card  
Please Fill Out  
And Mail Immediately



NO POSTAGE  
NECESSARY  
IF MAILED  
IN THE  
UNITED STATES

**BUSINESS REPLY MAIL**  
FIRST CLASS MAIL Permit No 195 Marshfield, WI 54449

POSTAGE WILL BE PAID BY ADDRESSEE

**H&S Manufacturing Co., Inc.**  
PO Box 768  
Marshfield WI 54449-9963

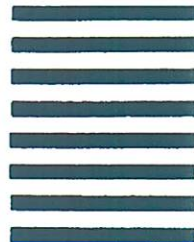

AFTER COMPLETION, DEALER SHOULD REMOVE AND RETAIN FOR RECORDS

**H&S  
DEALER PRE-DELIVERY CHECK LIST**

After Hay Tedder has been completely set-up, check to be certain it is in correct running order before delivering to the customer. The following is a list of points to inspect. Check off each item as you have made the proper adjustments and found the item operating satisfactorily.

- PTO Shields slide freely.
- All Shields and Guards are in place and fastened.
- All grease fittings have been lubricated - See lubrication guide in this manual.
- All mechanisms are operating trouble free.
- Belts are properly adjusted.
- All bolts and fasteners are tight.
- All decals are in place, and legible.

Dealer's Name	Model No.	Serial No.
(Signature of Pre-Delivery Inspector)		Date of Inspection

**DEALER DELIVERY CHECK LIST**

This check list that follows is an important reminder of valuable information that should be passed on to the customer at the time this Hay Tedder is delivered.

Check off each item as you explain it to the customer.

This pre-delivery check list, when properly filled out and signed assures the customer that the pre-delivery service was satisfactorily performed.

- Explain to the customer that pre-delivery inspection was made.
- Explain to the customer all the safety precautions they must exercise when operating this unit.
- Explain the adjustment for proper material fluffing.
- Explain to customer that regular lubrication is required for proper operation and long life of machine. Show customer the lubrication section of Owner's Manual.
- Give customer Owner's Manual and make sure he reads and understands all operating and service instructions.
- Enter Serial Number on Page 13 of this manual.
- Have customer sign a completed "Warranty Registration," and mail it promptly.

Date Delivered \_\_\_\_\_

Dealer's Name \_\_\_\_\_

By \_\_\_\_\_

\_\_\_\_\_  
Signature of Original Buyer

Note: Warranty is not valid until warranty card is completed and returned to H&S Mfg. Co., Inc.

Remove Dealers File Copy At Perforation)



**BE  
ALERT!**      **YOUR SAFETY  
IS INVOLVED.**

**THIS SYMBOL IS USED THROUGHOUT THIS BOOK WHENEVER YOUR PERSONAL SAFETY IS INVOLVED. TAKE TIME TO BE CAREFUL. REMEMBER: THE CAREFUL OPERATOR IS THE BEST OPERATOR. MOST ACCIDENTS ARE CAUSED BY HUMAN ERROR. CERTAIN PRECAUTIONS MUST BE OBSERVED TO PREVENT THE POSSIBILITY OF INJURY OR DAMAGE.**

**TRACTORS**

**This operator's manual uses the term "Tractor" when identifying the power source for the Hay Tedder.**

**H&S MANUFACTURING CO., INC.**

## RECOGNIZE SAFETY INFORMATION

This is the safety-alert symbol. When you see this symbol on your machine or in this manual, be alert to the potential for personal injury.

Follow recommended precautions and safe operating practices.



## UNDERSTAND SIGNAL WORDS

A signal word –DANGER, WARNING, or CAUTION– is used with the safety-alert symbol. DANGER identifies the most serious hazards.

Safety signs with signal word DANGER or WARNING are typically near specific hazards.

General precautions are listed on CAUTION safety signs.



## FOLLOW SAFETY INSTRUCTIONS

Carefully read all safety messages in this manual, and all safety signs on your machine. Follow all recommended precautions and safe operating procedures.

Keep signs in good condition. Immediately replace any missing or damaged signs.



**⚠ DANGER**



**ROTATING DRIVELINE CONTACT CAN CAUSE DEATH  
KEEP AWAY!**

**DO NOT OPERATE WITHOUT-**

- ALL DRIVELINE, TRACTOR AND EQUIPMENT SHIELDS IN PLACE.
- DRIVELINES SECURELY ATTACHED AT BOTH ENDS.
- DRIVELINE SHIELDS THAT TURN FREELY ON DRIVELINE.

1494L

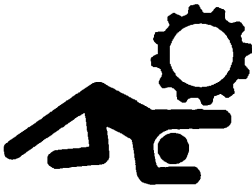

**⚠ DANGER**

**STAY CLEAR OF REEL AND ALL ROTATING PARTS WHEN TRACTOR IS RUNNING OR PTO IS ENGAGED. FAILURE TO HEED MAY RESULT IN SERIOUS INJURY OR DEATH.**

12494D

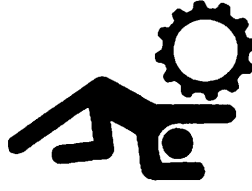

**⚠ DANGER**

**DO NOT SHIFT LEVER WHEN TRACTOR IS RUNNING OR PTO IS ENGAGED. FAILURE TO HEED MAY RESULT IN SERIOUS INJURY OR DEATH.**

12494E

**⚠ WARNING**



**DO NOT CLEAN OR WORK ON THIS MACHINE WITHOUT FIRST DISENGAGING POWER AND SHUTTING OFF TRACTOR ENGINE.**

1494J

**⚠ WARNING**



**DO NOT REMOVE SHIELDS MOVING PARTS INSIDE**

1494K

**⚠ WARNING**



**DO NOT OPERATE THIS EQUIPMENT IF THIS DECAL IS EXPOSED. REPLACE SAFETY SHIELDS. FAILURE TO HEED MAY RESULT IN SERIOUS INJURY OR DEATH.**

3394

**⚠ WARNING**

**HELP AVOID INJURY**

- READ & UNDERSTAND THE OPERATORS MANUAL PROVIDED WITH THIS MACHINE. IF MISPLACED CALL H & S MANUFACTURING AT 715-387-3414 WITH MODEL AND SERIAL NUMBER.
- UNDERSTAND ALL SAFETY WARNINGS AND FUNCTION OF CONTROLS.
- KEEP SAFETY DEVICES IN PLACE AND WORKING
- KEEP YOURSELF AND OTHERS WELL CLEAR OF MOVING PARTS.
- DISCONNECT ALL POWER BEFORE SERVICING OR CLEANING THIS MACHINE.
- DO NOT EXCEED 20 MPH

72203A



**⚠ WARNING**

**DO NOT REMOVE SHIELDS ROTATING PARTS INSIDE**

12794

**⚠ WARNING!**



**KEEP CHILDREN AWAY AT ALL TIMES!**

2495



# H&S HAY TEDDER



# W A R N I N G

## TO PREVENT SERIOUS INJURY OR DEATH

BEFORE YOU ATTEMPT TO OPERATE THIS EQUIPMENT, READ AND STUDY THE FOLLOWING INFORMATION. IN ADDITION, MAKE SURE THAT EVERY INDIVIDUAL WHO OPERATES OR WORKS WITH THIS EQUIPMENT, WHETHER FAMILY MEMBER OR EMPLOYEE, IS FAMILIAR WITH THESE SAFETY PRECAUTIONS.

KNOW HOW TO STOP MECHANISM BEFORE STARTING IT

If the machine becomes clogged, disengage the Power Take-off. Stop the tractor engine and allow all mechanisms to stop before cleaning or working on the machine.

**DO NOT** attempt to perform maintenance or repair with tractor running or PTO hooked up.

**DO NOT** step up on machine at any time.

**NEVER** manually feed material into the reel.

**DO NOT** allow minors to operate or be near the machine.

**DO NOT ALLOW PERSONNEL OTHER THAN THE QUALIFIED OPERATOR NEAR THE MACHINE.**

Before starting tractor, be sure PTO shields slide freely and PTO is securely locked to tractor.

**DO NOT** clean, adjust, or lubricate the machine when any part is in operation.

Keep hands, feet, and clothing away from REEL WHEN IT IS REVOLVING.

Loose or floppy clothing should not be worn by the operator.

Be sure the machine is clear of people, tools, and other objects before engaging PTO.

**NEVER** start Hay Tedder until all guards and safety shields are secured in place.

**DO NOT** adjust reel when machine is running.

**DO NOT** adjust ground height with the tractor running.

**NEVER** hook up 1000 RPM tractor to the Hay Tedder.

H&S Mfg. Co. always takes the operator and his safety into consideration and guards exposed moving parts for his protection. However, some areas cannot be guarded or shielded in order to assure proper operation. In addition, the operator's manual and decals on the machine itself warn you of further danger and should be read and observed closely.

**Study the Above Safety Rules**

**ATTENTION-BE ALERT-YOUR SAFETY IS INVOLVED**

# FIELD OPERATION

Your H&S Tedder delivers outstanding ground speed and yet gently fluffs up the hay. The height of hay pitching can be regulated by moving the adjustment lever (eight different settings), located on the left hand side of the Tedder.

	<b>⚠ DANGER</b> <b>DO NOT SHIFT LEVER WHEN TRACTOR IS RUNNING OR PTO IS ENGAGED.</b> <b><u>FAILURE TO HEED MAY RESULT IN SERIOUS INJURY OR DEATH.</u></b>
---	---

Adjustment Lever



While using your H&S Tedder, which is capable of tedding quickly and efficiently, you might want to change the adjustment lever to make it more efficient. As various conditions will effect the efficiency of your Tedder, only with experience will you know how to properly adjust the Tedder. Field conditions, weather conditions, and type and size of windrow or swath are some of the determining factors for proper teeth adjustment, height adjustment, and PTO and ground speed to make your Tedder most efficient in gently picking up and fluffing all the hay.

## HEIGHT ADJUSTMENT

Located between hitch and gearbox mount is the height adjustment rod. This adjustment controls the height of the reel in relation to the ground. Shortening adjustment rod will raise reel, while lengthening it will lower it. A convenient handle is provided to turn adjustment rod.

<b>⚠ WARNING</b>

<b>DO NOT CLEAN OR WORK ON THIS MACHINE WITHOUT FIRST DISENGAGING POWER AND <u>SHUTTING OFF TRACTOR ENGINE.</u></b>

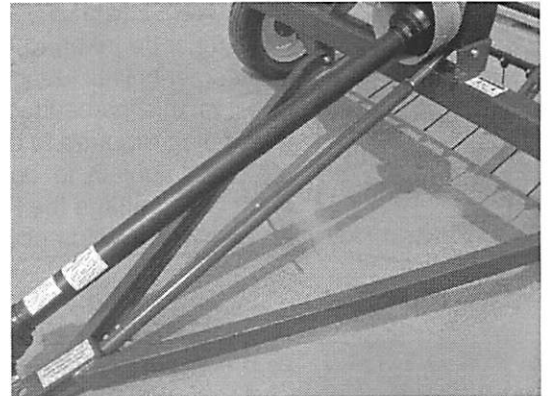

## ADJUSTMENTS

1. The V-Belts absorb shock and prevent damage to the machine should the reel strike an obstruction. Adjust the belts by loosening the two bearing mounting bolts (A) on each end of the reel. Turn the adjusting bolts (B) on each side of the Tedder equally so the reel runs parallel with the frame. Adjust the belt to about 1/2 inch deflection. Then secure the reel bearing bolts tightly to the frame.
2. To adjust the wheel hubs, tighten the castellated nut on the spindle to the point where there is no end play and a slight drag on the bearing.



## FIELD OPERATION (Continued)

### PTO HOLDER

A convenient bracket is provided to hold PTO when Tedder is not in operation. Locking PTO onto holder will also prevent reel from turning during road travel.

### LUBRICATION

The operator should become familiar with all lubrication points, and establish a systematic routine to insure complete and quick lubrication of the machine. Life expectancy of this or any other machine is dependent on regular maintenance including lubrication, and bolt torque

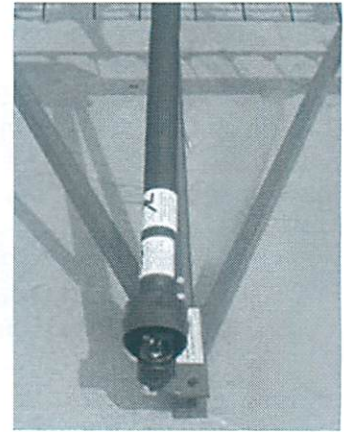

### GEAR BOX

Before using your new machine, check the oil in the gear box, keep filled to the center of the shafts. Use 80W-90W gear lube.

Both wheel axle bearings have been packed with grease at the factory. However, they should be checked periodically to insure proper operation.

### PTO ASSEMBLY

Care must be taken to keep the male and female driving elements well lubricated and free sliding. Failure to observe this precaution will result in excessive pressure being required to collapse and extend the assembly while subject to operating torque. This excessive force may damage the PTO assembly. DO NOT lubricate the shield surfaces, the shields must be kept dry, as dirt accumulation on them will cause these units to bind and not slide.

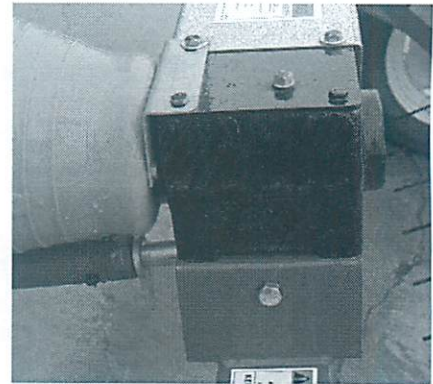

#### ⚠ WARNING



DO NOT CLEAN OR WORK ON THIS MACHINE WITHOUT FIRST DISENGAGING POWER AND SHUTTING OFF TRACTOR ENGINE.

#### ⚠ DANGER



ROTATING DRIVELINE CONTACT CAN CAUSE DEATH  
KEEP AWAY!

- DO NOT OPERATE WITHOUT-
- ALL DRIVELINE, TRACTOR AND EQUIPMENT SHIELDS IN PLACE.
- DRIVELINES SECURELY ATTACHED AT BOTH ENDS.
- DRIVELINE SHIELDS THAT TURN FREELY ON DRIVELINE.

### GREASE FITTINGS

There are 33 grease fittings on this machine. If these are lubricated properly and often enough it will prolong the life of the Tedder. Grease daily during normal use, and before and after storage. Use a good grade of high quality grease, make certain that the grease fittings are free of paint and dirt. Grease them until grease comes out around the shaft on the sleeve type bearings. On the sealed ball bearings, grease should be added slowly until a slight bead forms at the seals indicating the correct amount of lubricant. Wipe off the excess grease to prevent the accumulation of chaff and grit around the bearings.

### LOCATION OF GREASE FITTINGS (Illustrated on opposite page)

- A. (2) One at each end of PTO at U-joint
- C. One on hitch adjustment rod
- D. One on front jack shaft (sealed bearing)
- E. (2) One at each end of reel main shaft (sealed bearing)
- F. (12) One at end of each arm of each reel cross
- G. (12) Three on each set of cam arms
- H. One on cam center bearing

# GREASE FITTING LOCATION

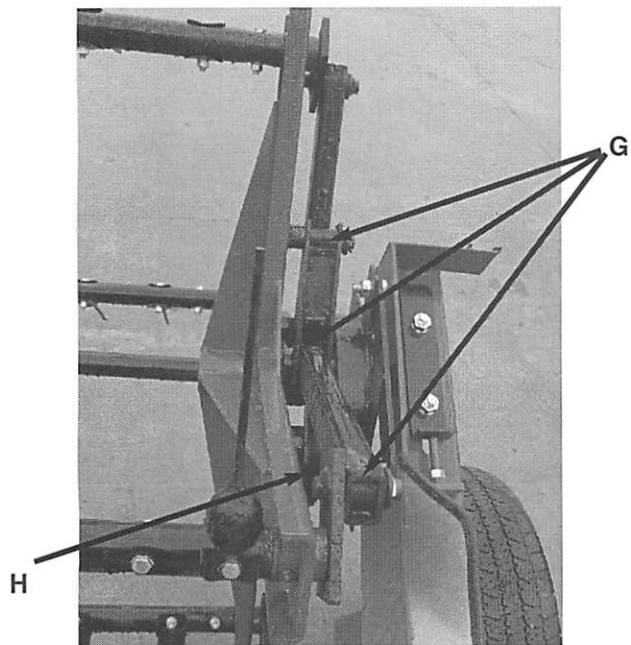
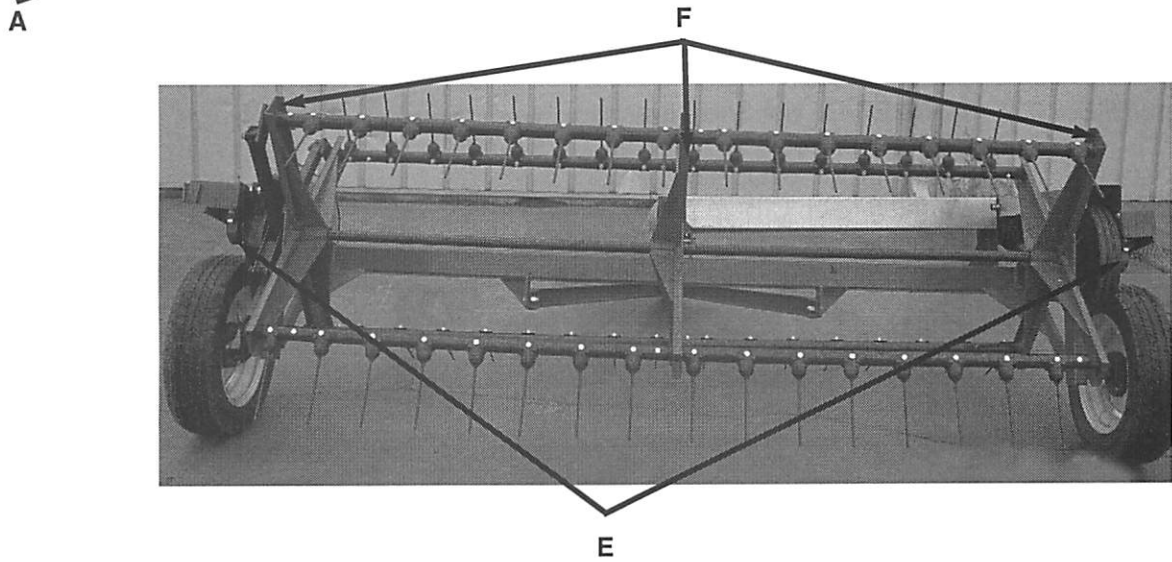
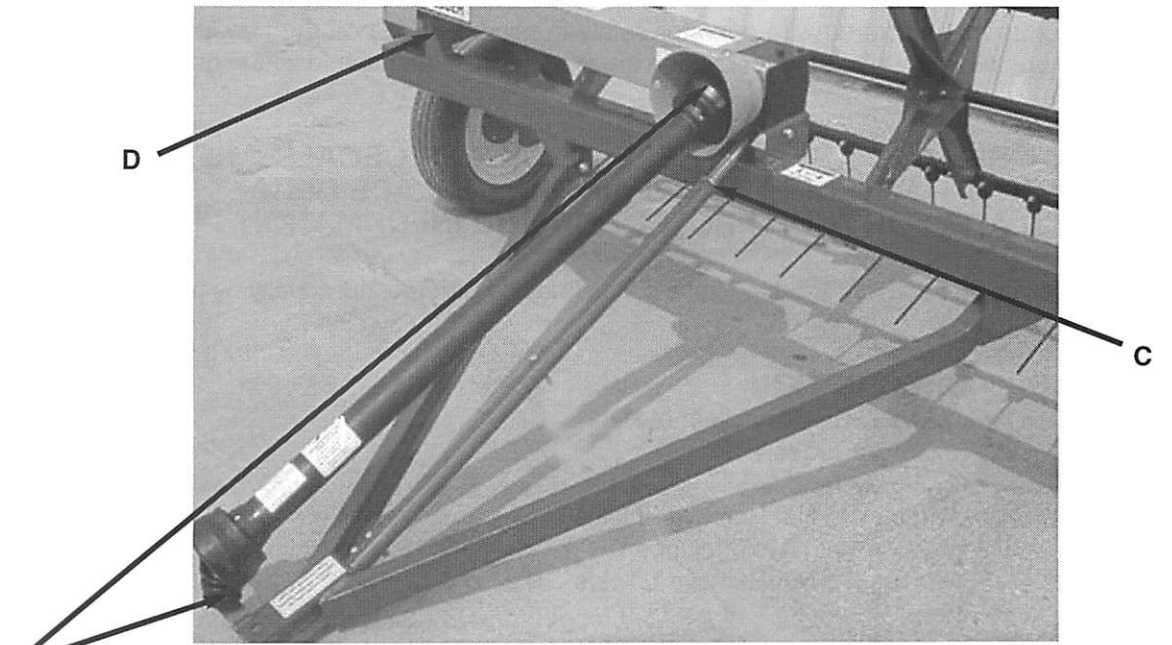

# DECAL LOCATION

Your H&S Hay Tedder was manufactured with operator safety in mind. Located on the Hay Tedder are various decals to aid in operation, and warn of danger or caution areas. Pay close attention to all the decals on your Hay Tedder.



**DO NOT REMOVE ANY OF THESE DECALS. IF DECALS ARE LOST, DAMAGED, OR IF HAY TEDDER IS REPAINTED, REPLACE DECALS. REMEMBER: DECALS ARE FOR YOUR PROTECTION AND INFORMATION.**

Listed below are the decals on your Hay Tedder. These decals may be ordered individually by part number or by ordering a complete set.

ITEM	PART NO.	DESCRIPTION
A	12494D	(4) DANGER-Stay Clear of Reel
B	1787C	(2) 7' Hay Tedder
	1787D	(2) 8' Hay Tedder
C	1494K	Warning-Do Not Remove Shields
D	72203A	Warning-Help Avoid Injuries
E	12794	Warning-Do Not Remove Shields
F		Serial Number
G	1787G	PTO Holder
H		WEASLERDANGER-PTO (H&S Decal 1494L)
I	1494J	Warning-Do Not Clean
J		Amber Reflector
K	12494E	DANGER-Do Not Shift Lever
L		(2) Red Reflector
M	3894	Warning-Do Not Operate
N	2495	Warning-Keep Children Away
	11604-7	Complete Set of Decals-7' Tedder
	11604-8	Complete Set of Decals-8' Tedder
Paint - H&S Red		
	ZX21	Gallon
	ZX22	Quart
	ZX23	Pint

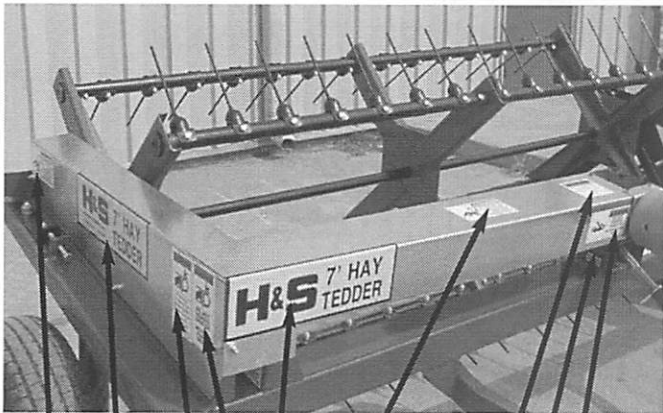

A B I C B A D F E

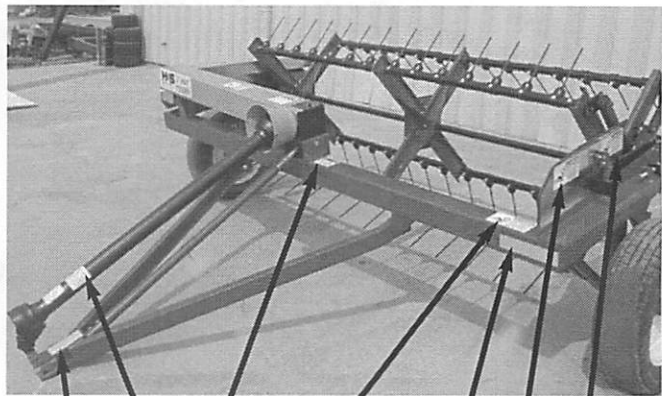

G H N A J K A

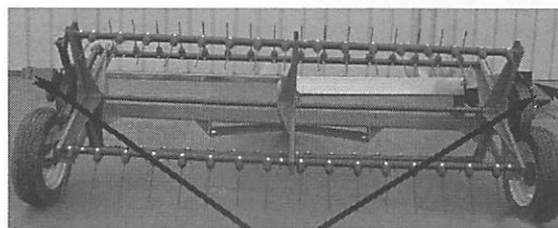

L

M  
(Located Behind Shield)

# Instructions for Ordering Parts

All service parts should be ordered through your H&S dealer. He will be able to give you faster service if you will provide him with the following:

1. Model of Tedder  
Serial number -
2. All references to left or right, apply to the machine as viewed from rear.
3. Parts should not be ordered from the illustration only. Use complete parts number and description, as shown in the parts lists.
4. If the dealer has to order the part - give the shipping instructions.  
VIA truck - large pieces (Specify local delivery truck line)  
VIA United Parcel Service

<b>H&amp;S MFG. CO. INC.</b>	
MARSHFIELD, WIS.	
MOD. NO.	<input type="text"/>
SER. NO.	<input type="text"/>
DESCR.	<input type="text"/>

Record numbers in spaces provided above from the Serial Number tag off machine, as a handy record for quick reference.

## ABOUT IMPROVEMENTS

H&S is continually striving to improve its products.

We must therefore, reserve the right to make improvements or changes when it becomes practical to do so, without incurring any obligation to make changes or additions to the equipment previously sold.

FIGURE 1

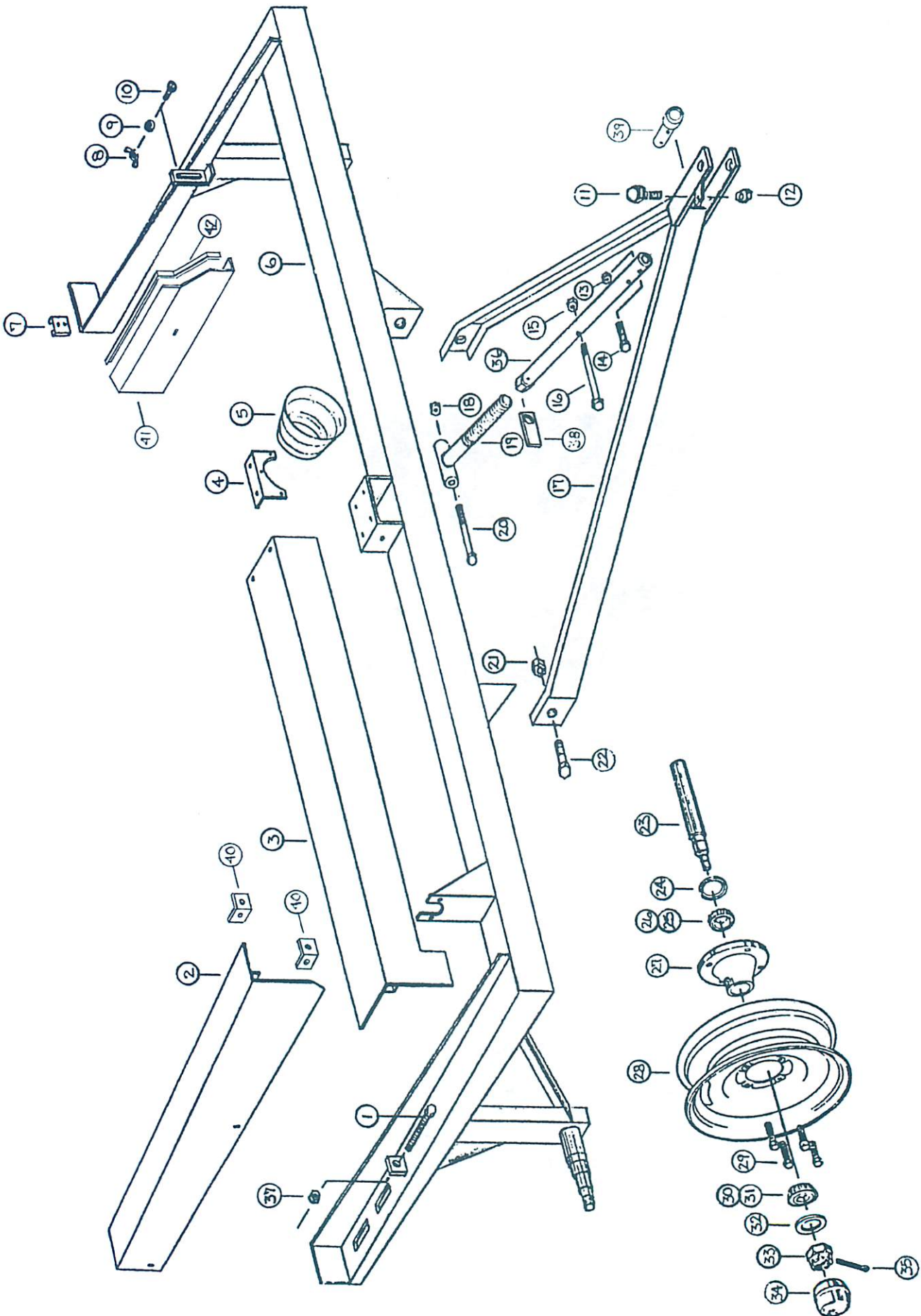

**FIGURE 1  
FRAME & SHIELDS**

ITEM	DESCRIPTION	7'	8'
1.	Tightener Bolt 1/2"x4-1/2"	"	9S16
2.	Side Shield	"	T10
3.	Front Shield	T711	T11
4.	Gear Box Shield	"	T12
5.	Gear Box Plastic Shield	"	T13
6.	Tedder Main Frame	T714	T14
7.	SMV Holder	"	F97
8.	Wing Nut	"	T15
9.	1/4" Flat Washer	"	T16
10.	Carriage Bolt 1/4"x3/3"	"	T17
11.	PTO Holder	"	T18
12.	1/2" Lock Nut	"	R11
13.	3/8" Lock Nut	"	A14
14.	3/8" x 2" Bolt Grade 5	"	T114
15.	3/8" Lock Nut	"	A14
16.	3/8" x 6" Bolt	"	T20
17.	Pole for Tedder	"	T21
18.	1/2" Nut	"	R29
19.	Adjustment Screw	"	T22
20.	1/2"x6-1/2" Bolt	"	X99
21.	3/4" Lock Nut	"	T23
22.	3/4"x2" Bolt	"	T24
23.	Spindle	"	T25
24.	Seal CR-14975	"	T26
25.	Bearing LM67048	"	T27
26.	Face LM67010	"	T28
27.	Hub	"	T29
28.	Rim	"	T30
29.	Hub Bolt	"	T31
30.	Bearing LM11949	"	T32
31.	Face LM11910	"	T33
32.	Washer	"	T34
33.	Nut	"	T35
34.	Hub Cap	"	T36
35.	Cotter Pin	"	T37
36.	Adjustment Pipe	"	T117
37.	1/2" Nut	"	R29
38.	Adjustment Lock	"	T118
39.	Adjustment End Shaft	"	T119
40.	Shield Angle	"	T120
41.	LH Side Shield	"	T121
42.	Plastic Edge For Shield	"	T124

NOTE: " (Same Part No. As 8' Model)



FIGURE 2

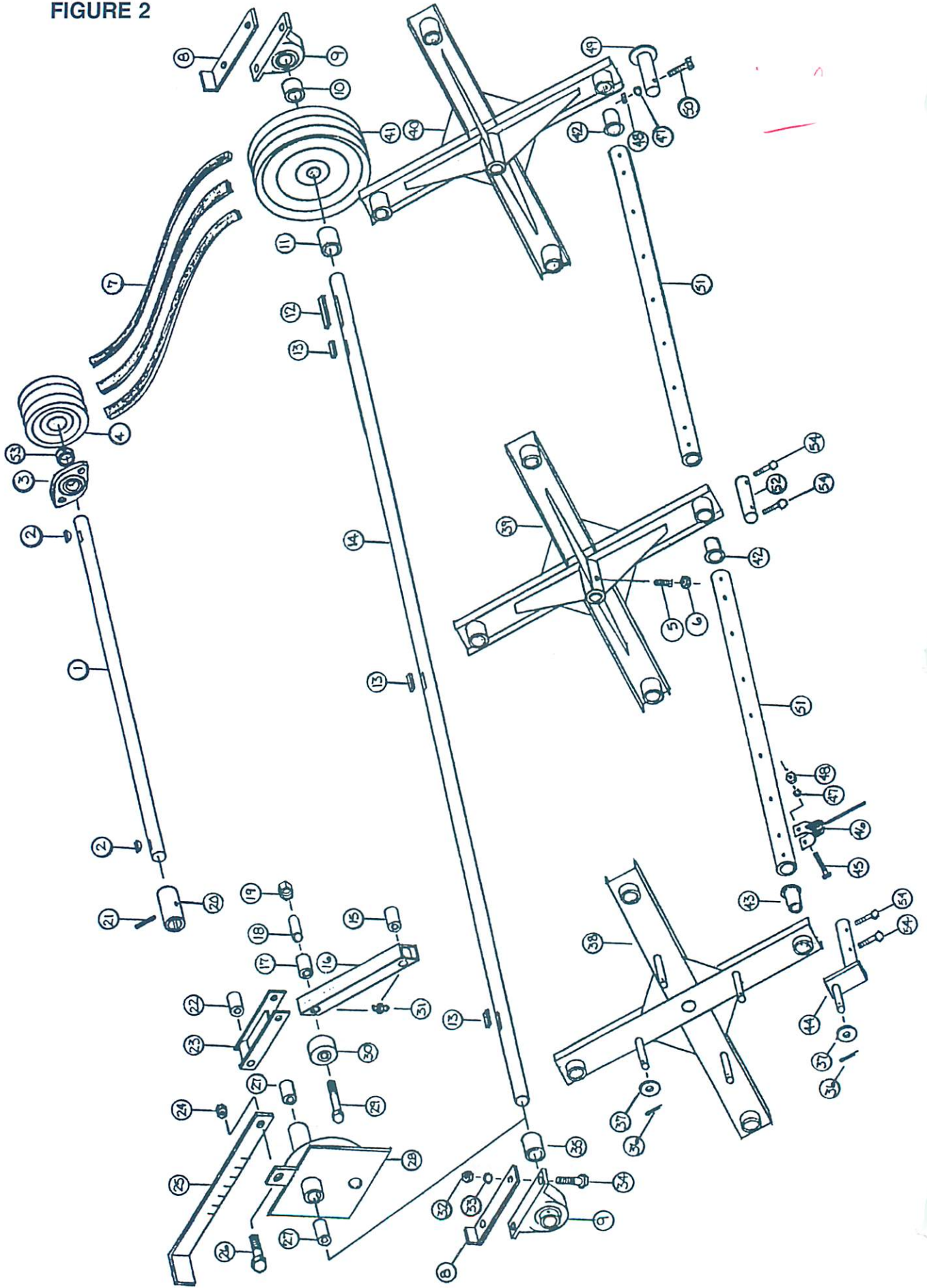

**FIGURE 2**  
**CAM AND BELT DRIVE ASSEMBLY**

ITEM	8'	7'	DESCRIPTION
1.	T39	T739	Front Shaft
2.	5B10	"	1/4" x 1" Woodruff Key
3.	T40	"	Bearing
4.	T260	"	Pulley
5.	T115	"	Set Screw for Reel
6.	T116	"	5/16" Nut
7.	T44	"	V-Belt
8.	T45	"	Tightener Brackets
9.	T46	"	Bearing
10.	T47	"	Spacer 1-3/8"
11.	T48	"	Spacer 2-5/8"
12.	T49	"	5/16" x 4" Sq. Key
13.	T50	"	5/16" x 2" Sq. Key
14.	T51	T751	Reel Shaft
15.	T52	"	Bronze Bushing 3/4" I.D. (8)
16.	T53	"	Cam Long Arm
17.	T52	"	Bronze Bushing 3/4" I.D. (8)
18.	T122	"	Steel Bushing 5/8" I.D. (4)
19.	T60	"	5/8" Lock Nut
20.	T57	"	Gear Box Connector
21.	3G22	"	Roll Pin 5/16" x 1-3/4"
22.	T58	"	Bronze Bushing 3/4" I.D. (4)
23.	T59	"	Cam Short Arm
24.	T60	"	5/8" Lock Nut
25.	T61	"	Cam Handle
26.	T62	"	5/8" x 1-1/2" Bolt
27.	T63	"	Bronze Bushing 1-3/8" I.D. (2)
28.	T64	"	Cam Assembly
29.	T65	"	5/8" x 4 Bolt
30.	T66	"	Cam Roller Bearing
31.	T67	"	Grease Zerk (long)
32.	T68	"	5/8" Nut
33.	T69	"	5/8" Lock Washer
34.	T70	"	5/8" x 2 Bolt
35.	T71	"	Spacer 1"
36.	T72	"	Cotter Pin 5/32 x 1-1/2
37.	T73	"	Washer
38.	T74	"	LH Reel Cross
39.	T75	"	Center Reel Cross
40.	T76	"	RH Reel Cross
41.	T77	"	Pulley
42.	T78	"	Bronze Bushing 1-1/4" I.D. (8)
43.	T79	"	Bronze Bushing 1-1/4" I.D. (4)
44.	T80	"	LH Stub Shaft
45.	T123	"	3/8" x 2-1/4" Bolt Grade 5
46.	T82	"	Rubber Mounted Teeth
47.	B68	"	3/8" Lock Washer
48.	K60	"	3/8" Nut
49.	T83	"	RH Stub Shaft
50.	T19	"	3/8" x 2 Bolt Grade 5
* 51.	T84-9	T784-8	Reel Pipe
	T84-10	T784-9	Reel Pipe
52.	T85	"	Center Stub Shaft
53.	4C9	"	Lock Collar
54.	T123	"	3/8" x 2-1/4" Bolt Grade 5 (Thru Teeth)
	T114	"	3/8" x 2" Bolt Grade 5 (Thru pipe)

NOTE: " (Same Part No. As 8' Model)

NOTE: " (Same Part No. As 8' Model)

ITEM	DESCRIPTION	MODEL & PART NO.
1.	Dust Cap	X2
2.	Snap Ring	3G10
3.	Race #15245	3G18
4.	Bearing #15101	3G7
5.	Nut	3G11
6.	Housing	3G1
7.	Plug	3G20
8.	Cover	3G3
9.	Gasket	3G2
10.	Gear 12T	X3G5
11.	Seal	3G9
12.	1/4x1-1/4 Square Key	S135
13.	5/16x1-3/4 Roll Pin	3G22
14.	1/4x1 Woodruff Key	5B10
15.	Gear Box Front Shaft	T86
16.	Gear Box Side Shaft	T87
17.	Snap Ring	3G21
18.	Gear 18T	X36
19.	Nut	3G4
20.	Complete Gear Box	T112

FIGURE 3  
BEVEL GEAR BOX

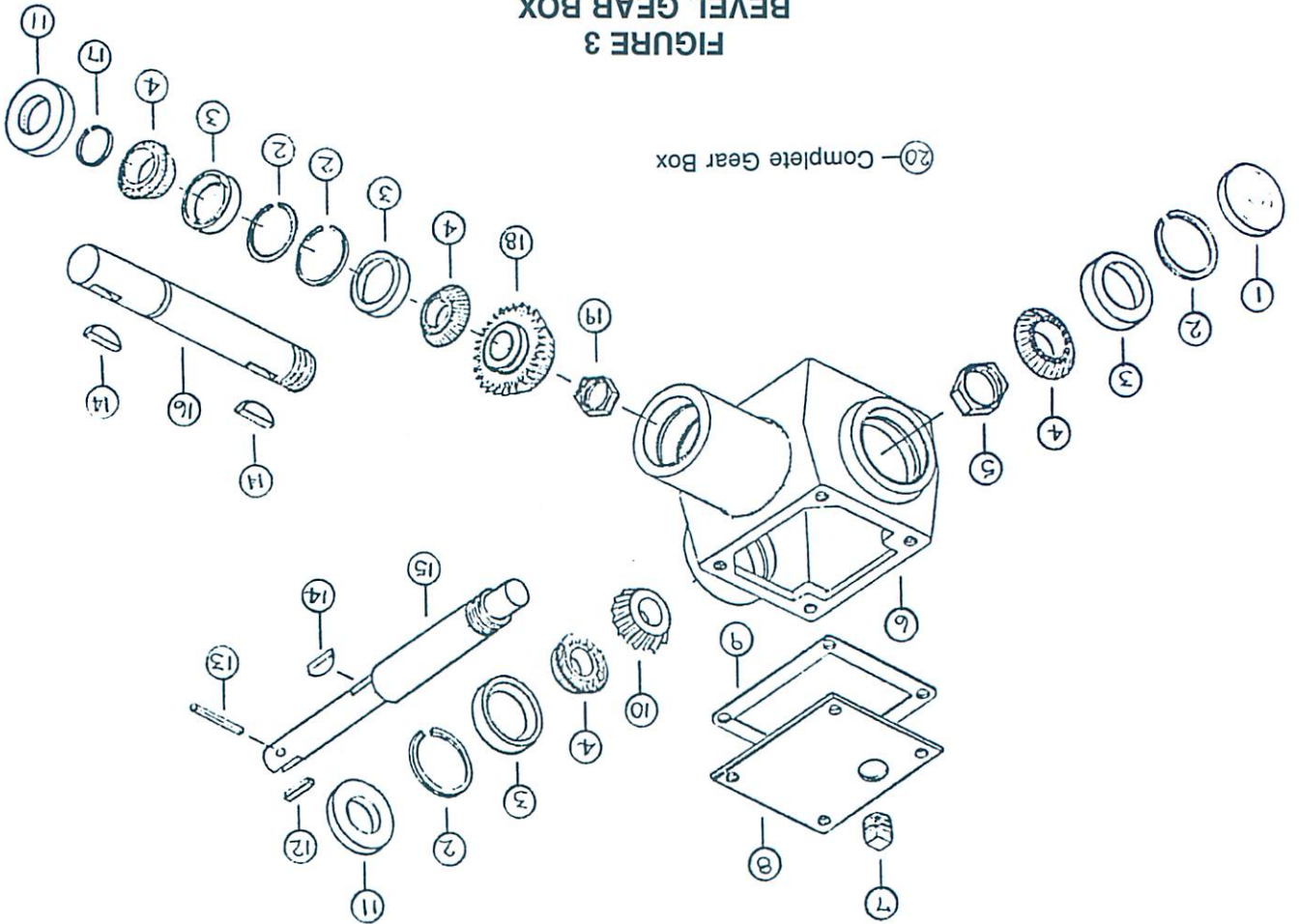
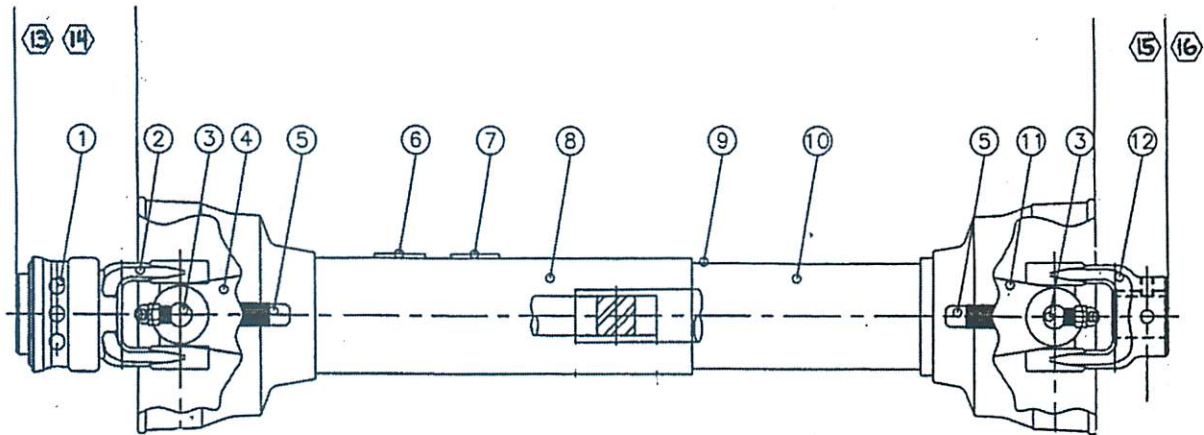

FIGURE 3

**FIGURE 4**  
**H&S HAY TEDDER PTO**  
~~(2005 Model Year Only)~~



**FIGURE 4**

ITEM	PART NO.	DESCRIPTION
1.	S225	Spring-Lok Repair Kit
2.	S224	Spring-Lok Yoke Assembly
3.	W-Kit	"W" Cross & Bearing Kit
4.	T266	Yoke & Shaft
5.	T267	Guard Repair Kit (Not Shown)
6.	16SV283	Safety Sign
7.	16SV384	Safety Sign-540 RPM
8.	T268	Outer Guard
9.	T269	Inner Guard
10.	16SV388	Safety Sign (Not Shown)
11.	T270	Yoke & Tube
12.	T271	Yoke
13.	T262	Joint & Shaft Half Assembly w/Guard
14.	T263	Joint & Shaft Half Assembly
15.	T264	Joint & Tube Half Assembly w/Guard
16.	T265	Joint & Tube Half Assembly
17.	T272	Complete PTO

*Handwritten notes:*

\* 2009  
 PTO Compl # T280 TRACTOR H&S Machine Half  
 \* T273  
 T282

**FIGURE 5**  
**H&S HAY TEDDER PTO**  
**(2006 Model Year and After)**

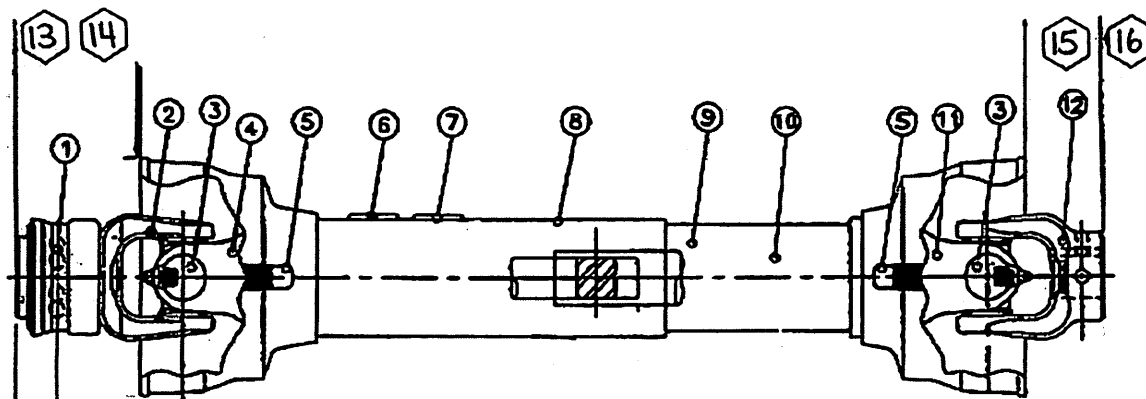

**FIGURE 5**

ITEM	PART NO.	DESCRIPTION
1.	S225	Spring-Lok Repair Kit
2.	S379	Spring-Lok Yoke Assembly
3.	T274	12P Cross & Bearing Kit
4.	T275	Yoke & Shaft
5.	S206	Guard Repair Kit (Not Shown)
6.	16SV283	Safety Sign
7.	16SV384	Safety Sign (540 RPM)
8.	T276	Outer Guard
9.	T277	Inner Guard
10.	16SV388	Safety Sign (Not Shown)
11.	T278	Yoke & Tube
12.	T279	Yoke
13.	T280	Joint & Shaft Half Assembly w/Guard
14.	T281	Joint & Shaft Half Assembly
15.	T282	Joint & Tube Half Assembly w/Guard
16.	T283	Joint & Tube Half Assembly
17.	T273	PTO Assembly Complete

## H&S 7' & 8' HAY TEDDER

Your new H&S Hay Tedder has been manufactured of the finest quality materials and components. The performance you get from your machine is largely dependent upon how well you read and understand this manual and apply this knowledge. There is a right and a wrong way to do everything. Please do not assume that you know how to operate and maintain your Haymachine before reading this manual carefully. Keep this manual available for ready reference.

## H&S 7' & 8' HAY TEDDER SPECIFICATIONS

DESCRIPTION	7 FT.	8 FT.
Drive.....	540 RPM PTO.....	540 RPM PTO
Tedding Width .....	7 ft.....	8 ft.
Overall Transport Width.....	10'2" .....	11'2"
Weight .....	870 # .....	900 #
Overall Height .....	50-1/2" .....	50-1/2"
Overall Length, w/Hitch.....	112" .....	112"
No. of Rubber Mounted Teeth .....	56 .....	64

## H&S MANUFACTURING CO. INC.

2608 S. Hume Ave.  
P.O. Box 768 - Telephone (715) 387-3414  
FAX (715) 384-5463  
MARSHFIELD, WI 54449



H&S WAREHOUSE Rt. #5 and 76  
P.O. Box 1260 - Telephone (716) 736-7595  
FAX (716) 736-7596  
RIPLEY, NY 14775

# **H&S MFG. CO.**

products approved

for the

## **FEMA SEAL OF QUALITY**

